

## VSLDSMAR – DRUVA®PUR SHUT-OFF VALVE

VALVE | PURE LINE (STAINLESS STEEL) | 20 m<sup>3</sup> SERIES | DIAPHRAGM SHUT-OFF VALVE  
| MANUAL ACTUATION | 2-PORT VERSION



2-port metal diaphragm shut-off valve is used in supply systems for pure, inert, flammable, oxidizing gases and gas mixtures. This stainless steel version valve is also usable for corrosive and toxic gases and gas mixtures. Maximum gas purity is 6.0.



### SPECIAL FEATURES:

- > Elgiloy diaphragm tightening system to atmosphere
- > Compact design
- > Designed and approved in accordance with relevant sections of ISO 10297:2015
- > Electrostatic chargeability test
  - Fulfills requirements according to ISO 80079-36; IEC TS 60079-32-1 and German TRGS 727
  - Usable in EX- areas zones 1 and 2 for gases with explosion risk group I; IIA; IIB; IIC

TECHNICAL DATA	
<b>Working temperature:</b>	-20 °C to +60 °C
<b>Inlet / outlet ports:</b>	1/4" NPT female Further connections – see technical drawing
<b>Max. working pressure:</b>	300 bar
<b>Cv-value:</b>	0,25
<b>Seat diameter:</b>	5 mm
<b>Leakage rate seat:</b>	<5x10 <sup>-6</sup> mbar l/s (Helium)
<b>Leakage rate outside:</b>	<1x10 <sup>-9</sup> mbar l/s (Helium)
<b>Filter</b>	1x for each inlet 1x for each outlet
<b>Weight:</b>	0,31 kg
<b>Material gas wettet parts</b>	
<b>Valve body:</b>	Stainless Steel
<b>Valve diaphragm:</b>	2x Elgiloy
<b>Valve seat:</b>	PCTFE
<b>Valve poppet:</b>	Stainless Steel
<b>Test in production:</b>	Pressure test with Helium of each item
	Seat leakage test with Helium of each item
	Helium leak test of each valve against atmosphere
	Test of functionality of each item
<b>Approvals during development:</b>	Type test in accordance with ISO 10297:2015
	Electrostatic chargeability test
	<ul style="list-style-type: none"> <li>• Fulfills requirements according ISO 80079-36, IEC TS 60079-32-1 and German TRGS 727</li> <li>• Usable in EX-areas zones 1 and 2 for gases with explosion risk group I, IIA, IIB, IIC</li> </ul>

## TECHNICAL DRAWING

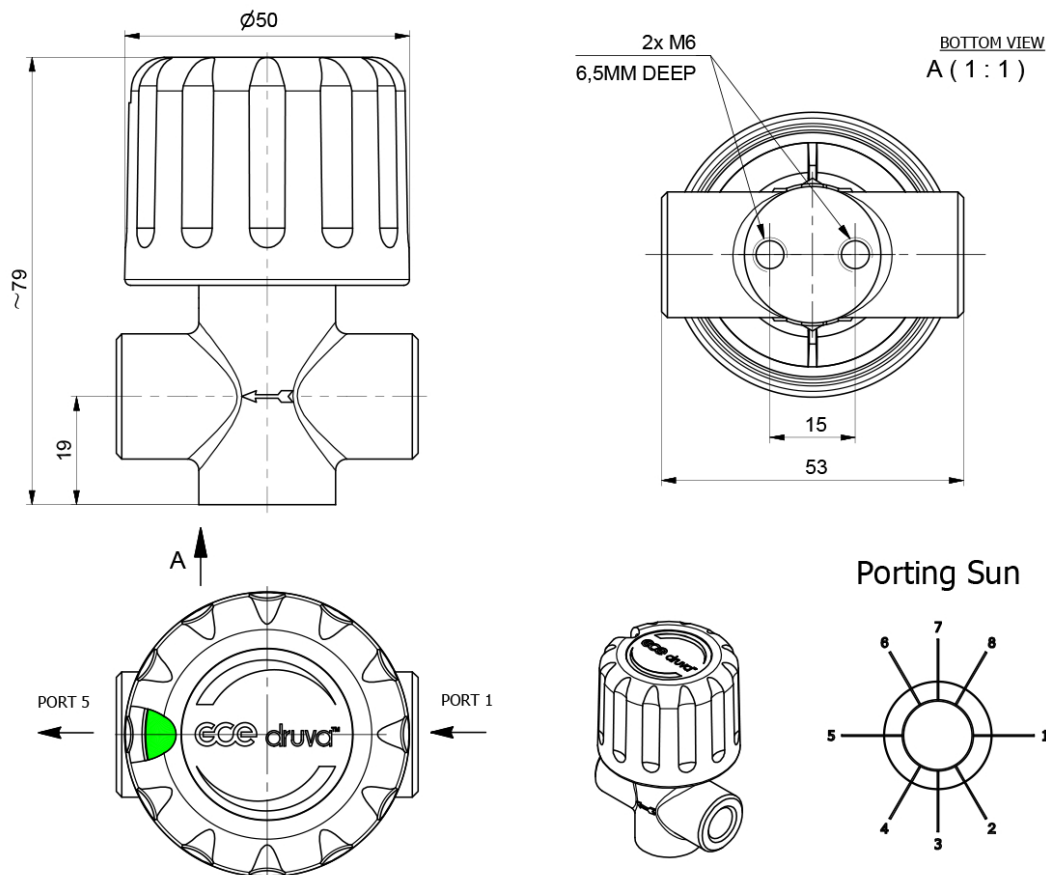

N14F - NPT1/4" female  
 0000 - Without (Port 3 and Port 7)  
 M03S - Compression Fitting  $\phi$  3MM SST  
 M06S - Compression Fitting  $\phi$  6MM SST  
 M08S - Compression Fitting  $\phi$  8MM SST  
 M10S - Compression Fitting  $\phi$  10MM SST  
 M12S - Compression Fitting  $\phi$  12MM SST

IX2S - Compression Fitting  $\phi$  1/8" SST  
 IX4S - Compression Fitting  $\phi$  1/4" SST  
 IX6S - Compression Fitting  $\phi$  3/8" SST  
 IX8S - Compression Fitting  $\phi$  1/2" SST

## ORDER CODE:

Example for a Valve | PUR Linie | Stainless Steel | Low Flow | Diaphragm Shut-off Valve | Manual Actuation | 2-Port Version

VSL	DS	M	AR	GX	N14F (1/4" NPT female)	0000	N14F (1/4" NPT female)	0000
	Type	Actuation	Porting Code	Working Pressure (bar)	Connection Port 1	Connection Port 3	Connection Port 5	Connection Port 7
	DS Diaphragm Shut-off Valve	M Manual	AR 2-Port (1 In   5 Out)	F1 130	possible connection  see technical drawing	0000 without	possible connection	0000 without
				GX 300			see technical drawing	

Order code (as described above) without special characters or spaces! Complete Order Code **VSLDSMARGXN14F0000N14F0000**

